

Key

01A ADVANCED WARNING ACCESS TO ROAD AHEAD CLOSED ON ____ TO ____ FOR ____ DAY(S) FROM ____ TO ____	01 ROAD CLOSED P7105 750mm	02 	04 Diverted traffic →	06 Diverted traffic ↑	08 Diversion ←	10 ROAD AHEAD CLOSED	12 Diverted traffic ↻	14 Diverted traffic ↻	15
		03 Diversion ENDS	05 Diverted traffic ←	07 Diversion →	09 Diversion ↑	11 Diverted traffic ↻	13 Diverted traffic ↻		

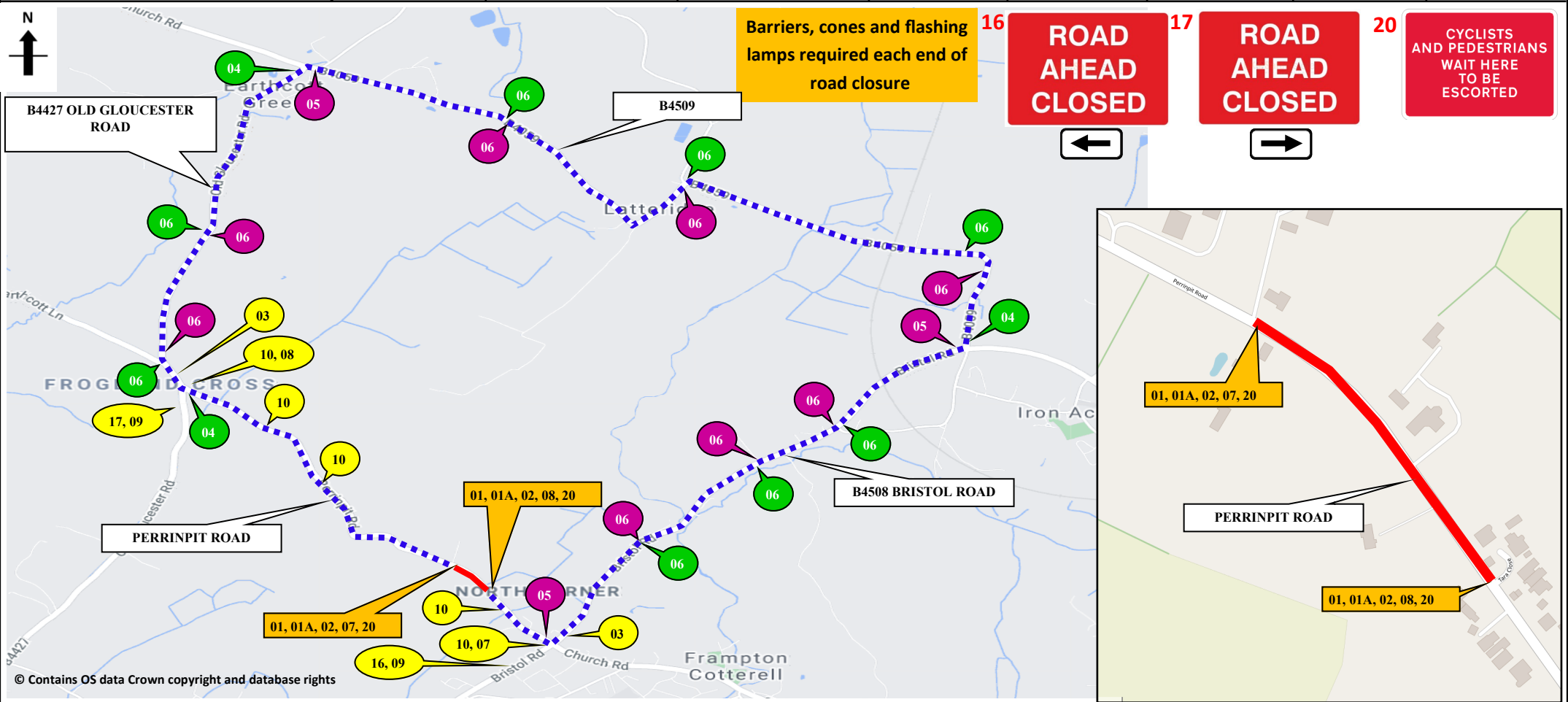

SUNBELT RENTALS

Sunbelt Rentals UK (Traffic Management)
Kemble Airfield Enterprise Park
Cirencester Road
Kemble
GL7 6BQ
☎ 03700 500 792
📠 0845 004 7105

Note

- All equipment shall be approved and shall comply with the Department Of Transport specification MCE0111. This drawing does not show the normal road works signage that will be required as per Chapter 8.
- All signs to be in accordance with TSGRD 2002 and to minimum class retroreflective.
- Minimum height of lettering to be 60mm and sign boards to be 1000mm (750mm where appropriate).

This drawing is protected by copyright and the information contained therein is confidential.
This drawing may not be copied and the information therein may not be used, or disclosed to a third party, wholly or in part with the written permission of Sunbelt Rentals UK (Traffic Management).

CROWN COPYRIGHT DATA REPRODUCED BY PERMISSION OF THE CONTROLLER OF HMSO

CLIENT DETAILS OPENREACH		REP/DEPOT DFP/213	DRAWN BY DFP/213	ADDRESS PERRINPIT ROAD FRAMPTON COTTERELL SOUTH GLOUCESTERSHIRE, BS36 2AT
DATE 19/09/2021	SHEET No 1 OF 1	VERSION NUMBER 001		
AMENDED DATE	AMENDED BY	SCALE NOT TO SCALE		
This layout is for installation by NRSWA, Lantra 12A,12B,,12D qualified persons.				BUS ROUTE AFFECTED

	ROAD CLOSURE		CLOCKWISE DIVERSION
	DIVERSION		ANTI-CLOCKWISE DIVERSION
	ROAD CLOSURE SIGN		
ROAD CLOSURE LENGTH (APPROX)		250M	
ROAD CLOSURE WIDTH (APPROX)		4.8M	
Contract Number 213-S009145			